

Wolter EC Bend Jet Fan - JFUB



- › Flexible installation through innovative product design & versatility
- › Tested in accordance to AMCA 210, 250, 300 standards
- › Lightweight construction
- › Maintenance Free
- › Maximum thrust & efficiency through CFD optimization
- › Energy saving & smart control options with EC technology
- › Bend and Twist - Adjustable outlet air profile angled towards specific areas

Technical Data

Fan Type Model Size	Motor Power [kW]	Rated Current [A]	Max.Fan Speed [1/min]	Max. Airflow [m ³ /s]	Thrust - [N]	Sound Pressure [dB(A) 3m/45°]	Weight [kg]
JFUB 315/280 A EE	0.32	2.35	2700	0.93	16	61	28
JFUB 315/315 A EE	0.32	2.35	2700	0.99	14	60	28

Performance Curves

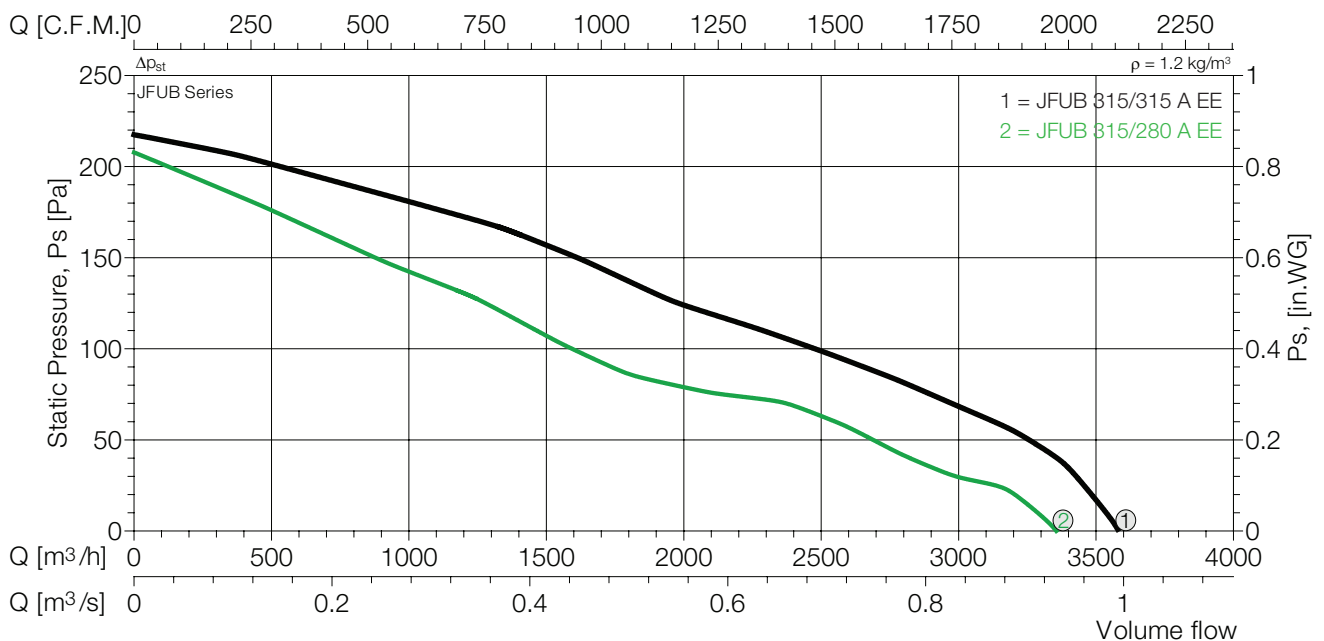

Dimensions

Standard Outlet at 0 deg

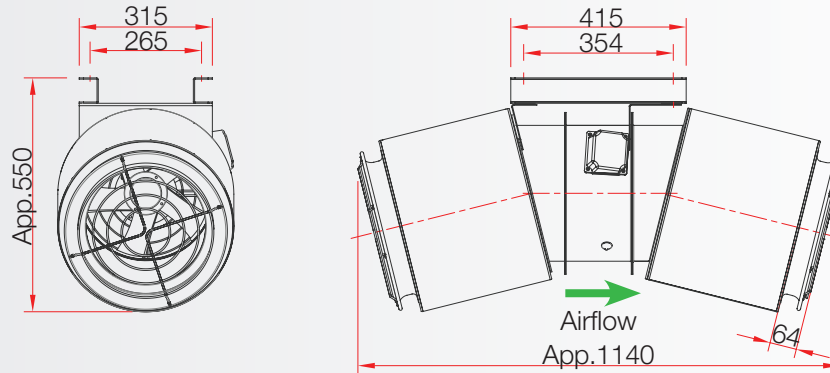

Outlet Twist Left 30 deg

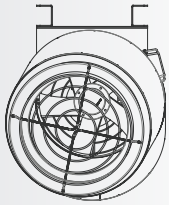

Outlet Twist Right 30 deg

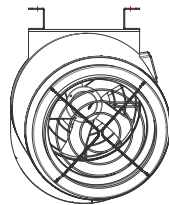

Outlet Twist Left 60 deg

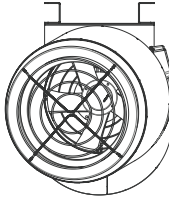

Outlet Twist Right 60 deg

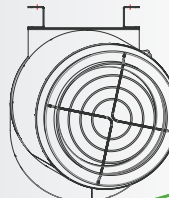

Outlet Twist Left 90 deg

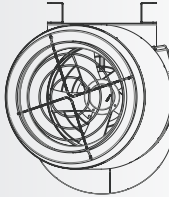

Outlet Twist Right 90 deg

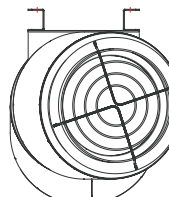

Fan Code

JF U B 315 / 280 A EE TR 30

Outlet Twist angle

TL = Twist left

TR = Twist right

Motor type

AE = Single phase AC

AD = Three phase AC

EE = Single phase EC

ED = Three phase EC

Impeller blade type

A = Propeller blade;

blank = Aero blade

Outlet Size

Inlet Size

Silencer version

O = Oval-Shaped

C = Round shaped

B = Bend

Airflow Version

U = Uni-Direction

R = Reversible

Jet Fan

Motor Wire Diagram

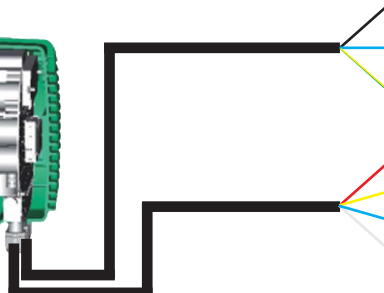
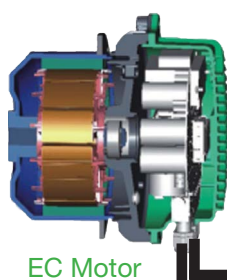

Single-phase power input:
AC 230V (110 ~ 270V)

L — Black
N — Blue
PE — Yellow / green

Control:

- ▶ 0 ~ 10V Output (Red)
- ▶ VSP / PWM (Yellow)
- ▶ GND (Blue)
- ▶ Tacho (White)