

Concrete Production

DRYBATCH® R01 Dust Collectors for Dry-Batch Concrete Plants



10



Description ▼

The polygonally shaped DRYBATCH® R01 Dust Collector is equipped with horizontally mounted filter elements, a compressed air jet cleaning system integrated in the access door and a suction fan.

Function

The DRYBATCH® R01 Dust Collector has been specially designed for dust collection from the truck mixer inlet zone in dry batch plants during filling of the truck mixer.



GROUND INSTALLATION



INSTALLATION ON TOP OF CEMENT WEIGH HOPPER

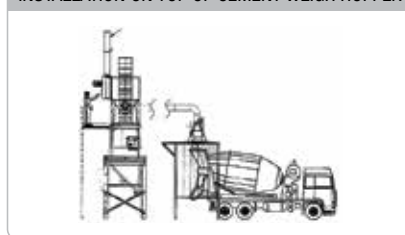
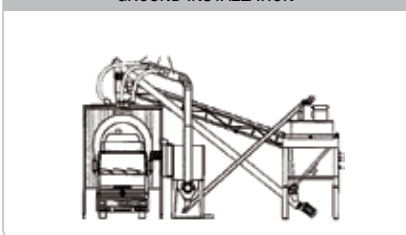

Application ▼

The DRYBATCH® Dust Collector can be installed as a stand-up unit on the ground next to the truck mixer port or on top of the cement weigh hopper.

Benefits ▼

- ✓ Maintenance time and cost reduction;
- ✓ Reduced energy consumption;
- ✓ Increased work safety;
- ✓ Durable.



Concrete Production

DRYBATCH® R01 Dust Collectors for Dry-Batch Concrete Plants



Technical Features / Performance ▼

- ▶ Horizontally mounted pocket filter elements
- ▶ Filter surface: 54 m² (580 sq ft)
- ▶ Filter media: polyester needle felt (500 g/m²)
- ▶ Reverse jet compressed air cleaning (min. 5 – max. 6 bar)
- ▶ Multi voltage electronic timer: 24 V – 260 V DC/AC 50/60 Hz
- ▶ 12 nos. solenoid valves
- ▶ Electronic pressure differential display meter (4 – 20 mA output)
- ▶ 11.0 kW (15.0 HP) suction fan
- ▶ Max. air volume capacity: 6,000 m³/h (3,530 cfm)
- ▶ 304 stainless steel body
- ▶ Seal frame in carbon steel powder-coated RAL 7001 (silver-grey)
- ▶ Diffuser and hammering device to break down the humidity

Overall Dimensions ▼

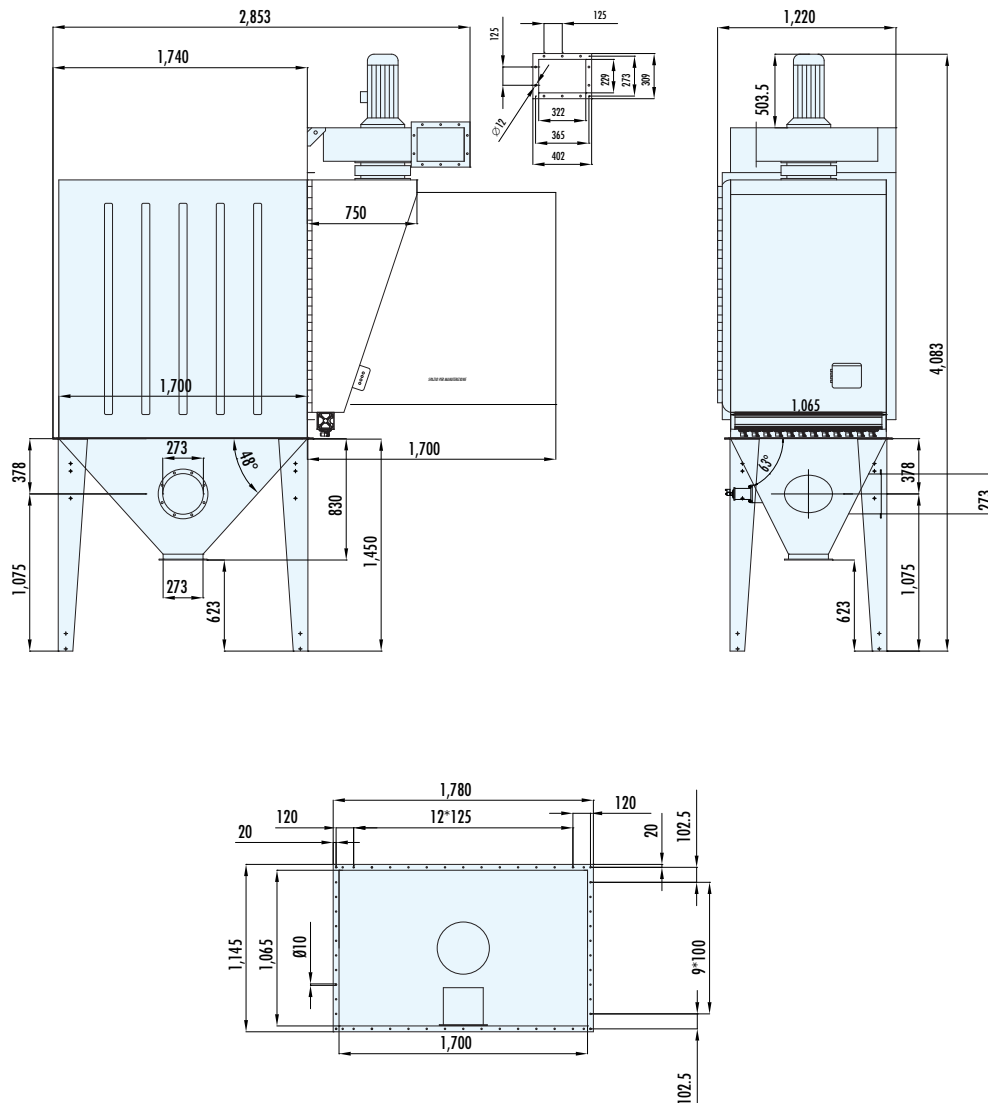

DS.11.DRYBATCH.R01.March 2014.100 Rights reserved to modify technical specifications.

This datasheet does not show the complete range but only the models most suitable for the application.



www.wamgroup.com